

## **AMENDMENT TO REGIME RULE 15**

Amended to: The maintenance, keeping, boarding, breeding and raising of poultry of any kind, regardless of number, shall be and is hereby prohibited within any condominium or upon any of the common elements except that this shall not prohibit the keeping of small household domestic pets such as dogs (1), indoor cats (2), and caged birds provided that they are not kept or maintained for commercial purposes or for breeding. Because of the inevitable stress which dogs place upon lawns and landscaping, no condominium unit shall contain more than one small dog, under thirty pounds in full grown weight.

The following four (4) areas within the Regime are designated as the SOLE areas for the curbing of dogs and are the ONLY areas in which it is acceptable for animals to relieve themselves:

1. The small meadow across Bickel, opposite the Regime entrance.
2. The opposite end of Crescent Spring Drive, behind and to the right of the stand of garbage cans, off the end of Building 16/Unit 376.
3. The intersection of Ledgeview Court and Ledgeview Park Drive, in the grassy area in front of the upper pool deck.
4. The small common element's island, directly in front of 367 Crescent Spring Drive next to the large tree.

At each location, there are waste bags and a collection basket. Owners are expected to remove their animal's solid waste and dispose of it in a sanitary manner. Should a dog relieve itself outside one of the designated areas, the owner is expected to immediately clean up after it. Failure to comply with the procedures will result in the assessment of fines.

In no event shall any animal be permitted in any of the common elements of the Regime unless carried or on a leash. Failure to comply will result in the assessment of fines.

If a dog or other animal becomes obnoxious to other unit owners by barking, biting, eliminating in undesignated areas or otherwise, the owner thereof must cause the problem to be corrected, or if it is not corrected, the unit owner, upon written request by the Board, shall be required to remove the animal from the Regime.

The owner of such an animal shall indemnify the Council and hold it harmless against any loss or liability of any kind or character whatsoever arising from or growing out of having any animal in the Regime.

### **Certificate of Adoption**

The undersigned, being all members of the Board of Administrators of the Regime, hereby adopt the Amendment to Regime Rule 15 of the Owners' Association on February 9, 2025.

The Board of Administration ratified and reaffirms the Regime Rule previously adopted, as amended, on January 6, 2016.

David Breckenridge

Chell Austin

Sharon Early

David Hackbart

Patty Schnatter



Pet "walk areas" with  
Pet Waste Stations



Large Dumpster locations



Ledgeview Park Drive  
Ledgeview Ct.



Crescent Spring Dr



302-312

3

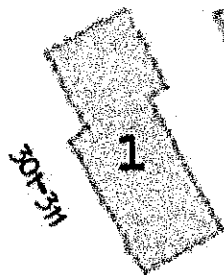

301-311

1

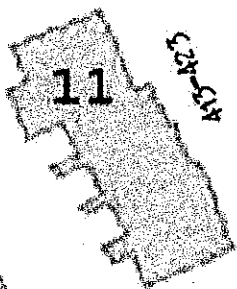

413-423

11

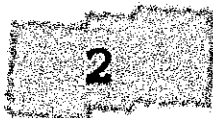

313-321

2



314-320

4



322-332

5



334-340

6



342-352

7

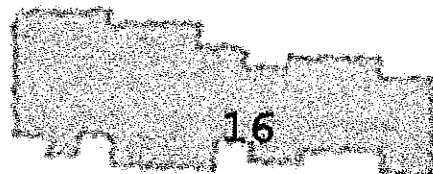

354-376

16



363-375

15

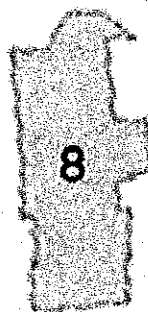

402-412

8

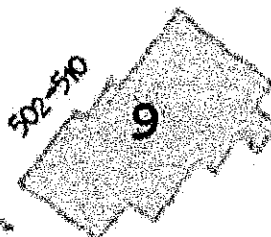

502-510

9

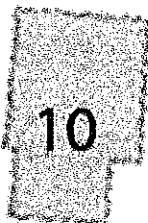

512-520

10

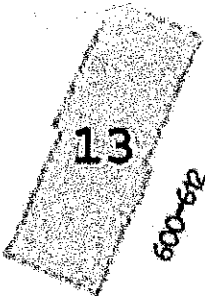

600-612

13

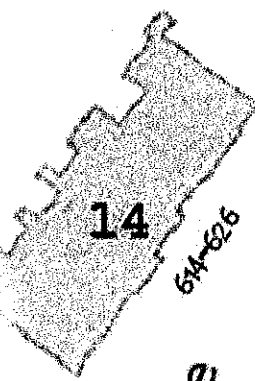

614-626

14